

BIANCO SHOWER BASE INSTALLATION INSTRUCTIONS

1. A) Make sure bottom timber plates of stud walls are checked out to enable plaster/AC sheet to cover external lips. Ensure waste hole is pre cut in correct position with enough clearance to easily connect trap.

B) If installing onto timber floor boards – the floor boards or sheet flooring must cover the entire underside of base. Cut a hole though the floor no greater than 200mm x 200mm.
Note: If doing a renovation please check floor boards for soundness, as rotting may have occurred and flooring may need replacing. (Disregard if installing onto concrete slab)
2. Lay appropriate amount of packing sand (Approx. 50-70mm) over entire area where base is to be installed and trowel off level – Lay your Pipers International Bianco shower base down.
3. Wiggle the base side to side and using a rubber mallet, tap down until external edges of base touch the floor.
4. Continually check levels of base edges to ensure they are level.
5. Seal external edge of the base to the floor and seal plaster/AC sheets around bottom to the base once installed.
6. Tile/Fix shower walls.
7. Remove protective coating (plastic) from base after all works are completed.

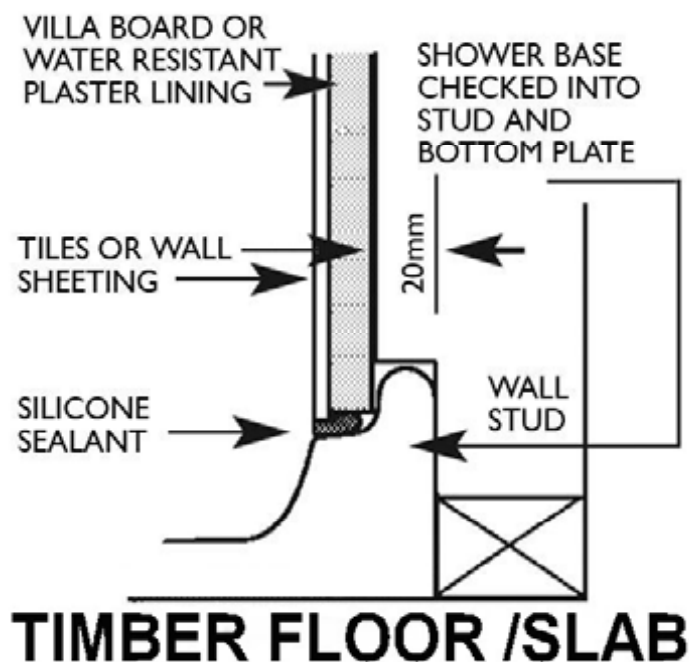

IMPORTANT NOTES:

1. Warranty will be voided if shower base is not installed by a licensed plumber/builder.
2. Please ensure that you install base in accordance to local by-laws.